



TO IGNITION SWITCH "ACC" TERMINAL  
(BLACK 18 AWG WIRE  
INCLUDED IN HARNESS KIT)  
WHERE IGN SWITCH HAS NO "ACC"  
TERMINAL, FOLLOW DASHED  
CONNECTION TO COIL +

TO IGNITION SWITCH  
"IGN" TERMINAL

TO START SOLENOID  
"BAT" TERMINAL  
(BLACK 14 AWG WIRE  
INCLUDED IN HARNESS KIT)

WHITE

BLUE

RED

ODR6 / ODR12

OVERDRIVE RELAY  
MODULE

4-WIRE CONNECTION SHOWN  
SEE REVERSE FOR THESE OTHER CONNECTION TYPES:  
3-WIRE (NO CONNECTION TO BATTERY)  
ORIGINAL OR REPRODUCTION RELAY  
VRODS1 12-TO-6 VOLT ADAPTER & RELAY MODULE

OVERDRIVE  
KICKDOWN  
SWITCH

RED

WHITE

ORANGE

YELLOW

OVERDRIVE  
SOLENOID

CHASSIS  
GROUND

4

BLUE

ORANGE

6

YELLOW

OVERDRIVE  
GOVERNOR

OVERDRIVE  
SHIFT RAIL  
LOCKOUT  
SWITCH

\*IF NOT PRESENT,  
CONNECT YELLOW  
WIRE TO  
GOVERNOR

## BORG-WARNER OD HARNESS INSTALLATION DIAGRAM

TO IGNITION SWITCH "ACC" TERMINAL  
 (BLACK 14 AWG WIRE INCLUDED IN  
 HARNESS KIT) WHERE IGNITION SWITCH  
 HAS NO "ACC" TERMINAL, CONNECT  
 TO IGNITION SWITCH "IGN" TERMINAL

**3-WIRE  
 CONNECTION  
 TO ODR6 OR  
 ODR12 RELAY  
 MODULE**

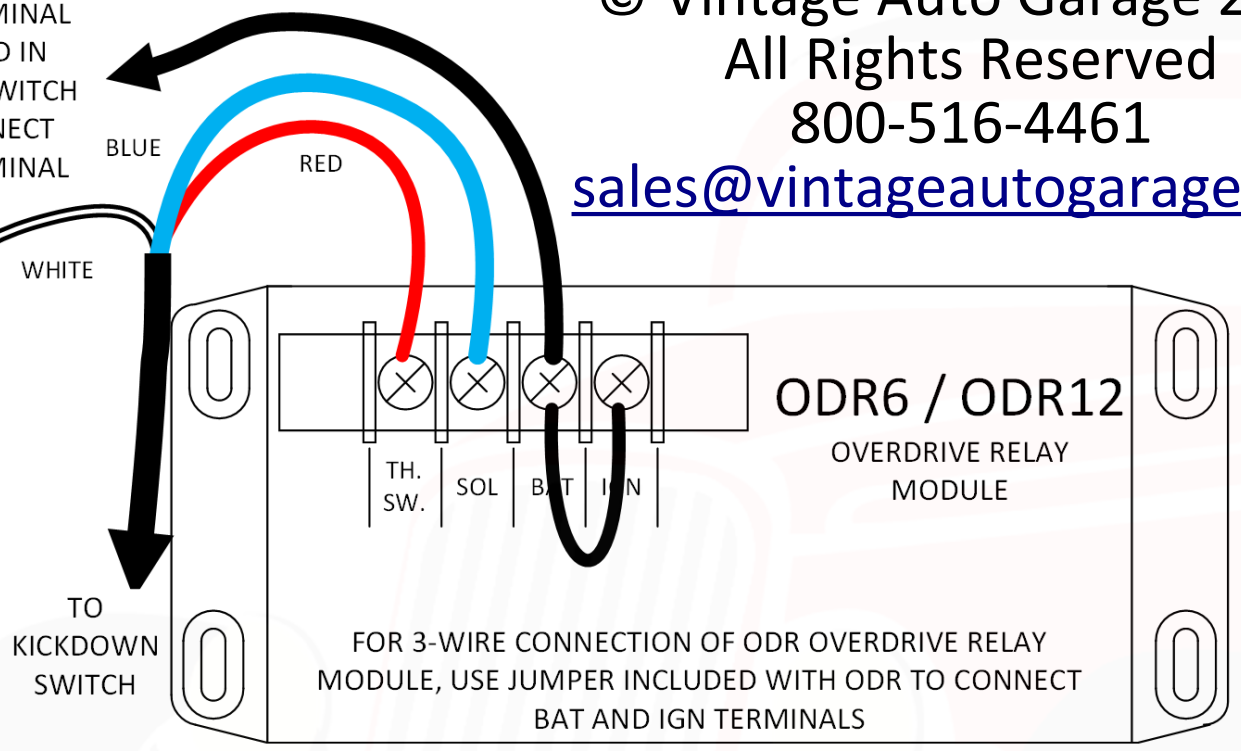

TO IGNITION SWITCH "ACC" TERMINAL  
 (BLACK 14 AWG WIRE INCLUDED IN  
 HARNESS KIT) WHERE IGNITION SWITCH  
 HAS NO "ACC" TERMINAL, CONNECT  
 TO IGNITION SWITCH "IGN" TERMINAL

**3-WIRE  
 CONNECTION TO  
 REPRODUCTION  
 ORIGINAL STYLE  
 OD RELAY**

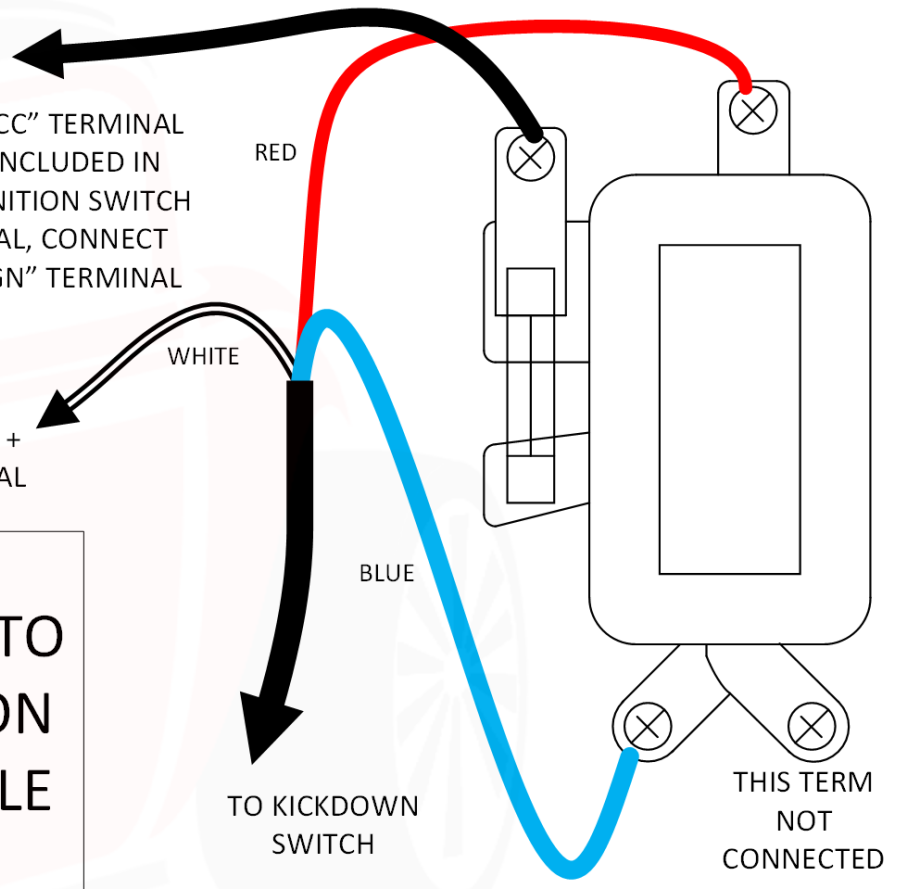

TO IGNITION SWITCH "ACC" TERMINAL  
 (BLACK 14 AWG WIRE INCLUDED IN  
 HARNESS KIT) WHERE IGNITION SWITCH  
 HAS NO "ACC" TERMINAL, CONNECT  
 TO IGNITION SWITCH "IGN" TERMINAL

**3-WIRE CONNECTION  
 TO VRODS1 VOLTAGE  
 ADAPTER & RELAY  
 MODULE**

VRODS1 ADAPTS 12-VOLT POWER FOR USE  
 WITH 6-VOLT OVERDRIVE SOLENOID. FOR  
 4 WIRE CONNECTION, SEE VRODS1  
 INSTRUCTION

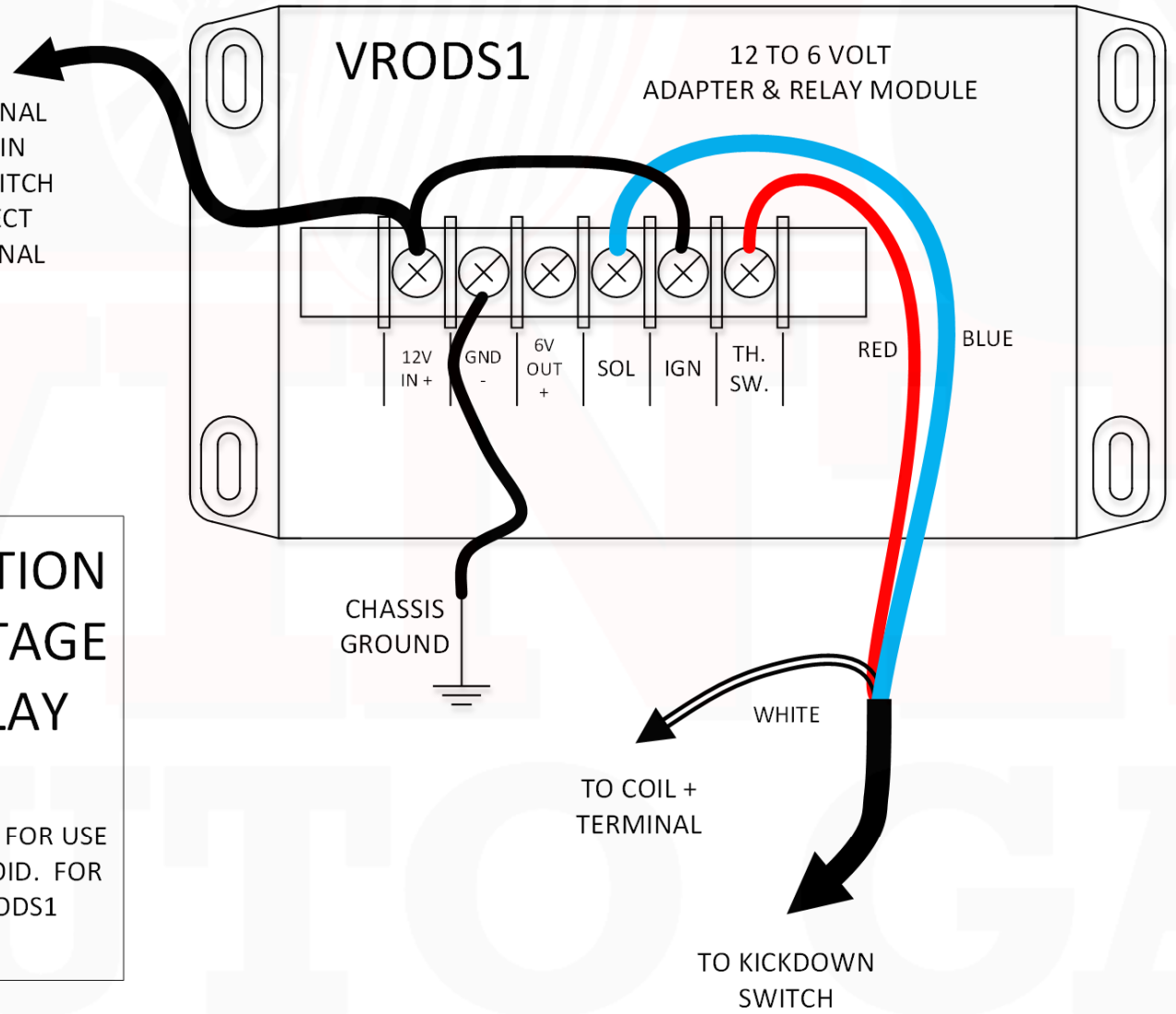

TO START SOLENOID  
 "BAT" TERMINAL  
 (BLACK 14 AWG WIRE  
 INCLUDED IN HARNESS KIT)

TO IGNITION SWITCH  
 "ACC" TERMINAL  
 (BLACK 18 AWG WIRE  
 INCLUDED IN HARNESS KIT)  
 WHERE IGN SWITCH HAS  
 NO "ACC" TERMINAL,  
 CONNECT TO COIL + AS  
 SHOWN ON OTHER SIDE

**4-WIRE  
 CONNECTION TO  
 ORIGINAL OD  
 RELAY**

